

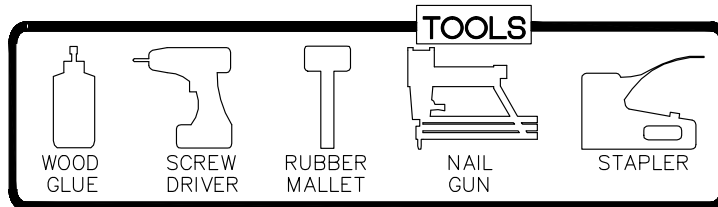

**ASSEMBLY INSTRUCTIONS - VANITY DRAWER BASE CABINET (3 DRAWERS)**

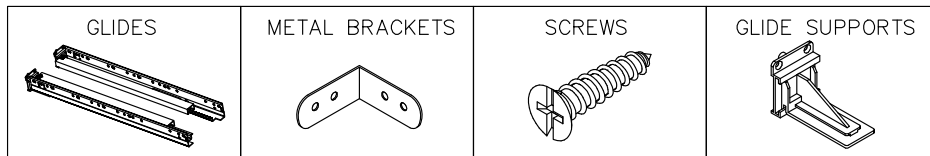
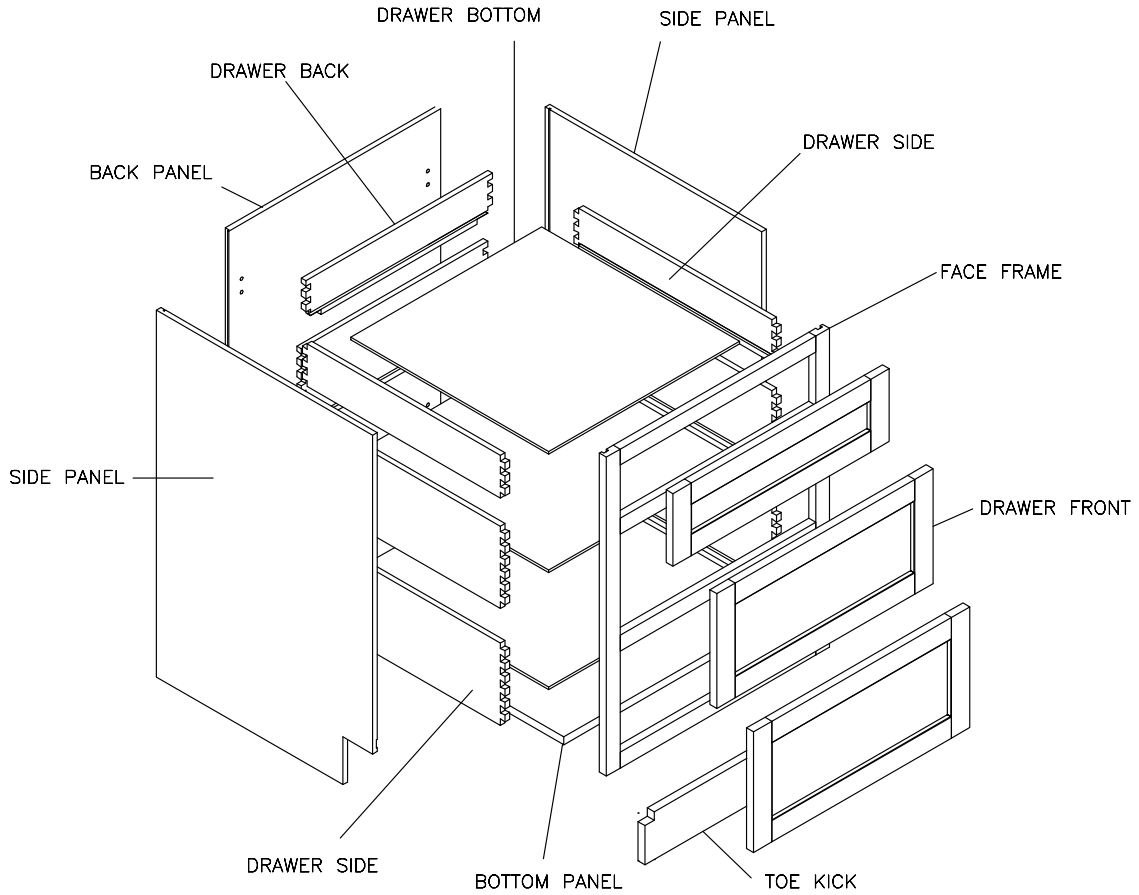

This instruction applies to the following items:

VDB12, VDB15, VDB18, VDB24



STEP 1

Glue each assembly slot

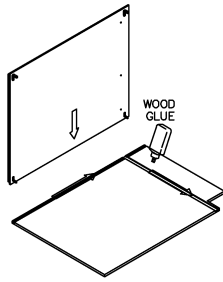

STEP 2

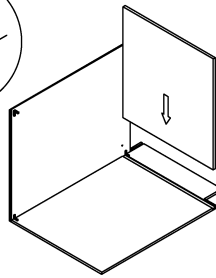

STEP 3

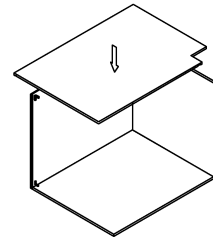

STEP 4

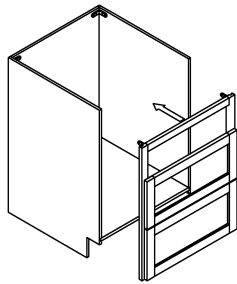

STEP 5

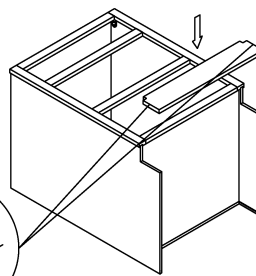
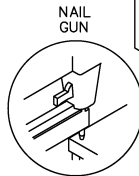

STEP 6

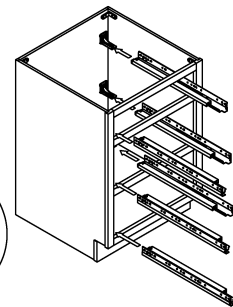
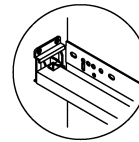

STEP 7

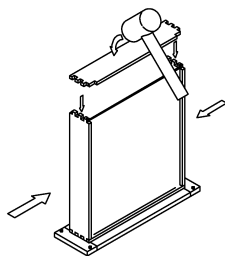

STEP 8

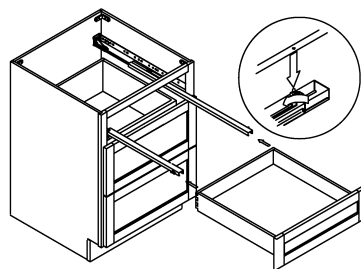
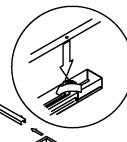

STEP 9

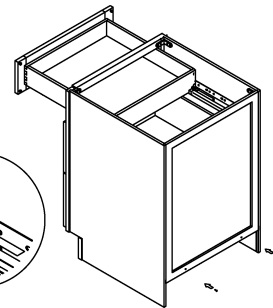
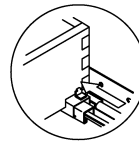

STEP 10

