

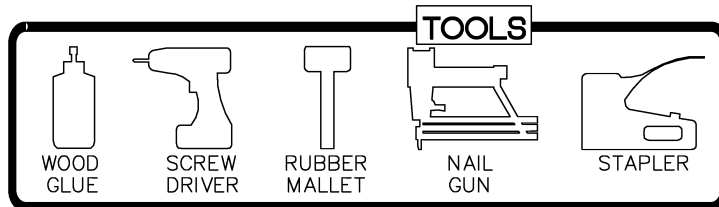

**ASSEMBLY INSTRUCTIONS - DRAWER BASE CABINET (3 DRAWERS)**

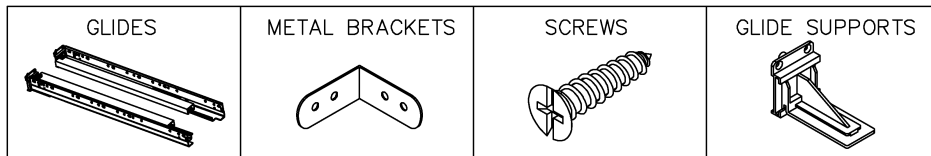

This instruction applies to the following items:  
DB12, DB15, DB18, DB21  
DB24, DB27, DB30, DB33, DB36

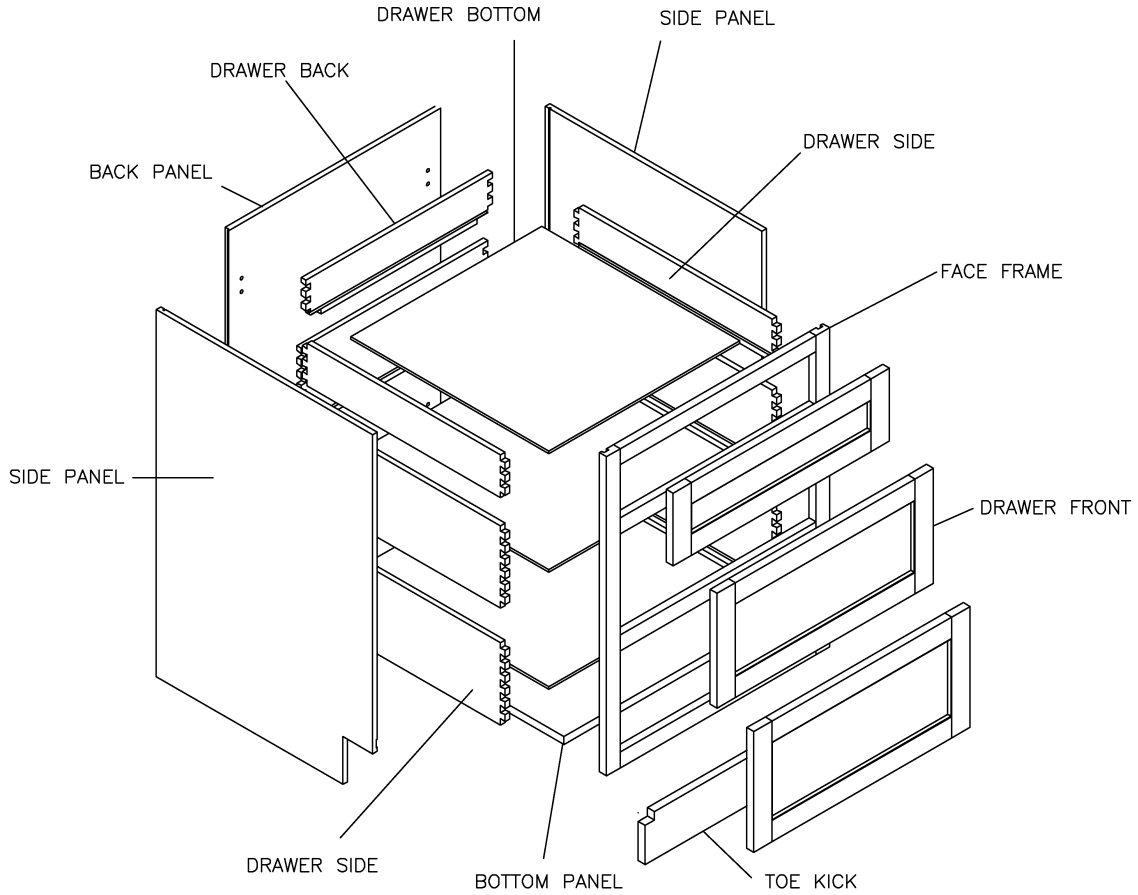

STEP 1

Glue each assembly slot

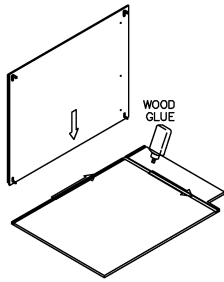

STEP 2

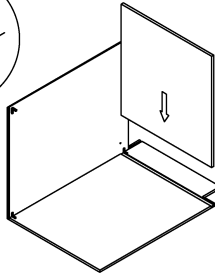

STEP 3

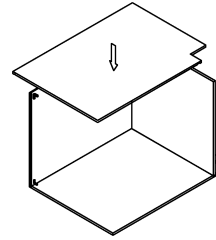

STEP 4

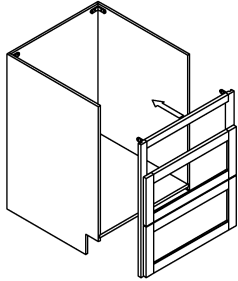

STEP 5

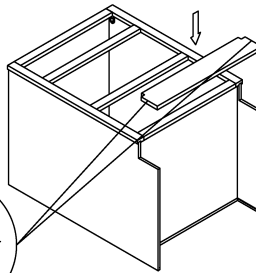
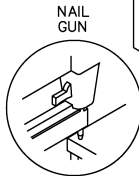

STEP 6

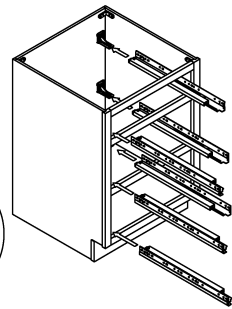
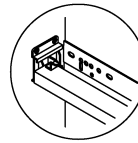

STEP 7

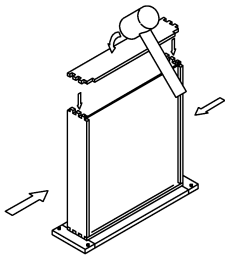

STEP 8

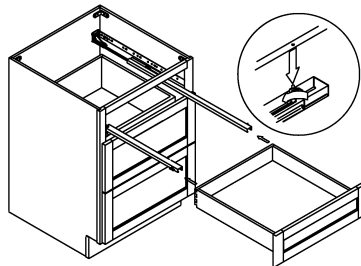
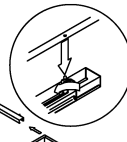

STEP 9

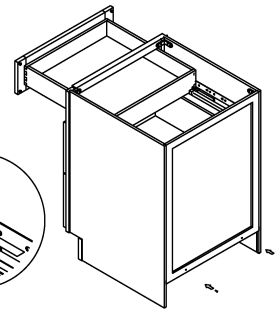
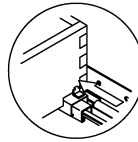

STEP 10

